



# INSTRUCTION BULLETIN

No. 9020937  
Machine: S30  
Published: 10-2023  
Rev. 00

**NOTE: DO NOT DISCARD the Parts List from the Instruction Bulletin. Place the Parts List in the appropriate place in the machine manual for future reference. Retaining the Parts List will make it easier to reorder individual parts and will save the cost of ordering an entire kit.**

*NOTE: Numbers in parenthesis ( ) are reference numbers for parts listed in Bill of Materials.*

Installation instructions for **kit number 9020927**

Kit installation must be performed by TennantTrue<sup>®</sup> service or an authorized service provider.

## SYNOPSIS:

This kit contains the parts needed to install the blue spotlight kit on S30 sweepers.  
Please follow step-by-step instructions.

## SPECIAL TOOLS/CONSIDERATIONS: NONE

(Estimated time to complete: 2 hours)



### PROTECT THE ENVIRONMENT

Please dispose of packaging materials, used machine components such as batteries and fluids in an environmentally safe way according to local waste disposal regulations.

Always remember to recycle.

## PREPARATION:

1. Stop the machine on a clean level surface, turn off the machine and remove the key.

**FOR SAFETY: Before leaving or servicing machine, stop on level surface, turn off machine, and remove key.**

2. Open the top cover, side shroud, and both rear engine covers.

3. If machine is equipped with plug fittings in the front lintel, remove and discard both plugs. (Fig. 1)

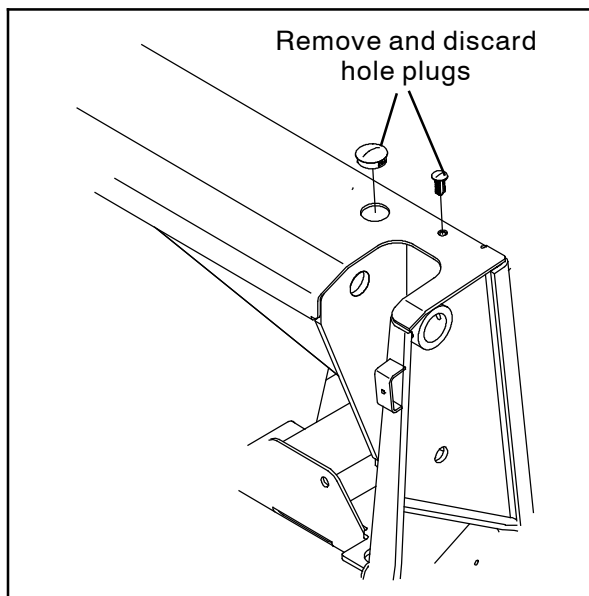

FIG. 1

## INSTALLATION:

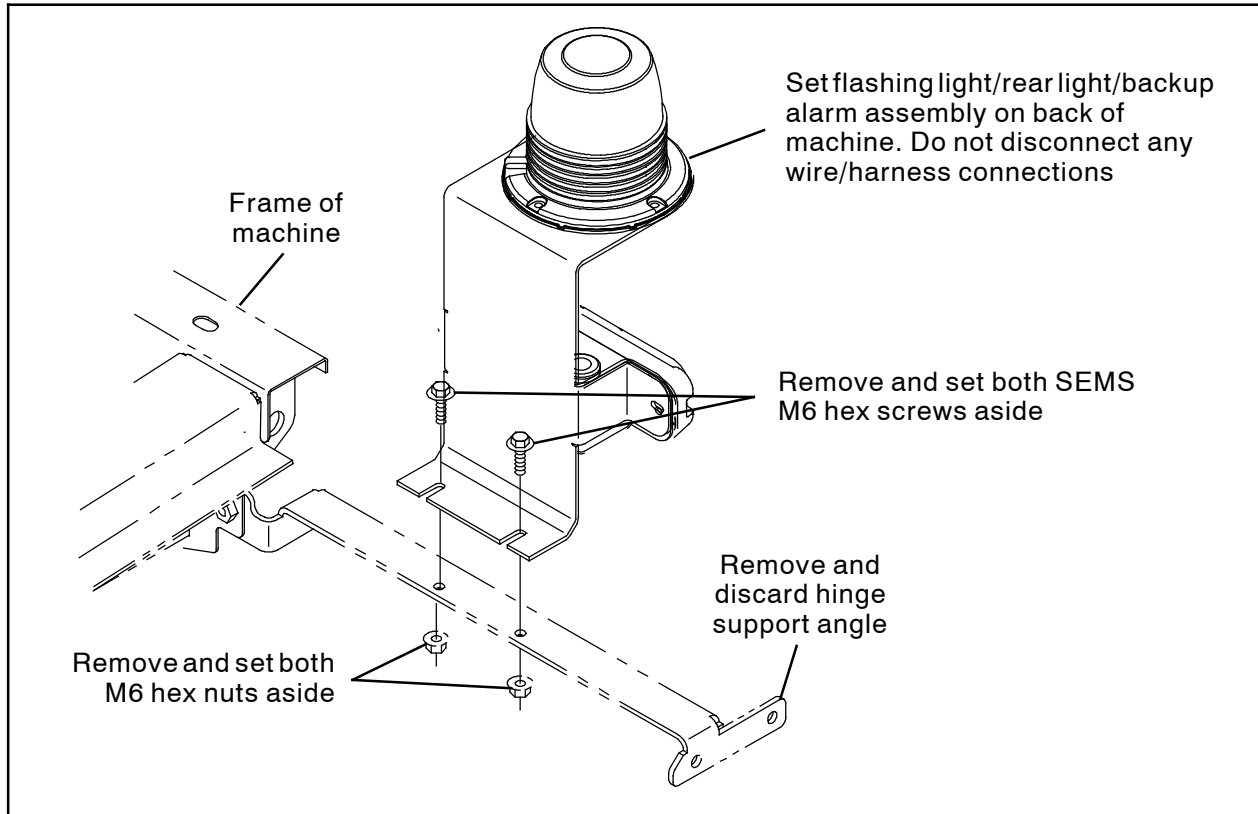

FIG. 2

1. **Machines equipped with flashing light/rear light/backup alarm assembly:** Remove the hardware securing the flashing light assembly to hinge support angle. Set the hardware aside. (Fig. 2)
2. **Machines equipped with flashing light/rear light/backup alarm assembly:** Carefully set the flashing light assembly onto the back of the machine. Do Not break wire/cable connections to the flashing light assembly. (Fig. 2)
3. Remove/loosen hardware as necessary to access the hex screw securing the hinge support angle to the frame of the machine. Set the hardware aside. (Fig. 2/Fig. 3/Fig. 4/ Fig. 5/Fig. 6)

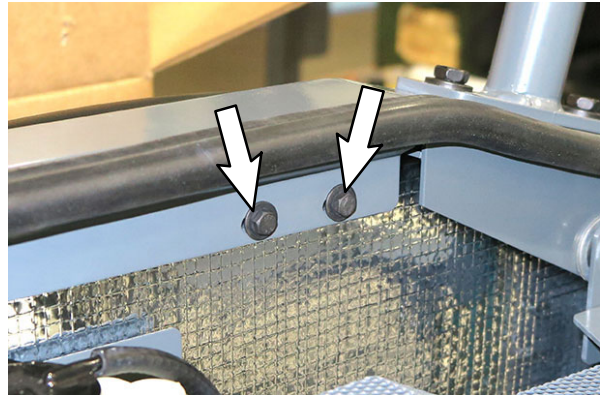

FIG. 3

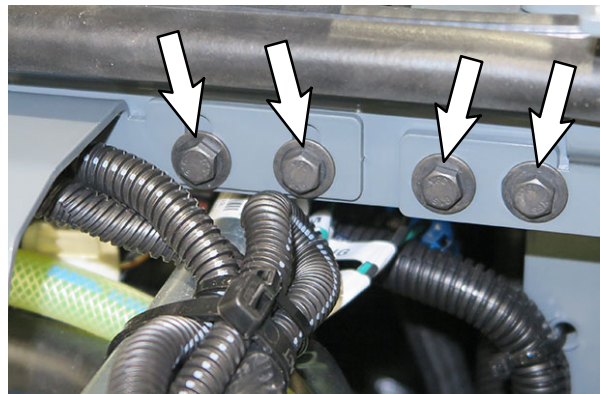
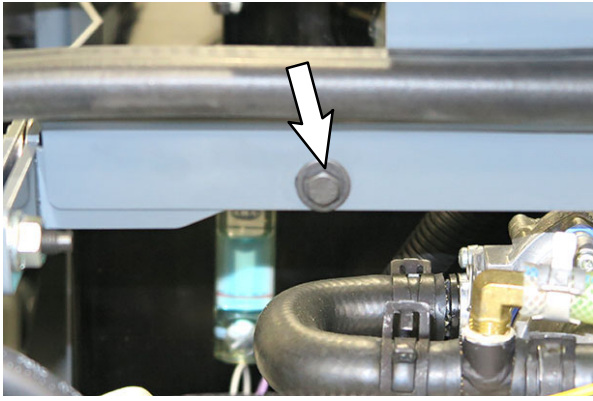
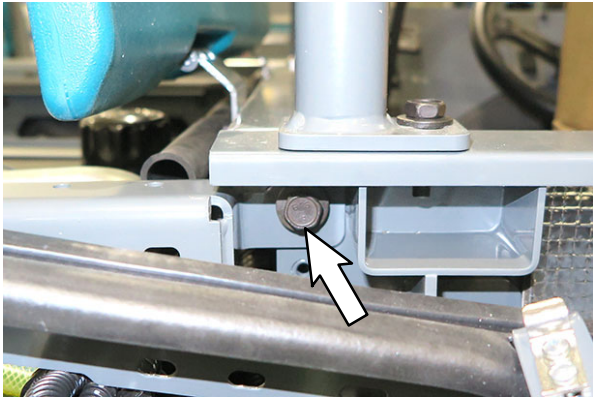

FIG. 4

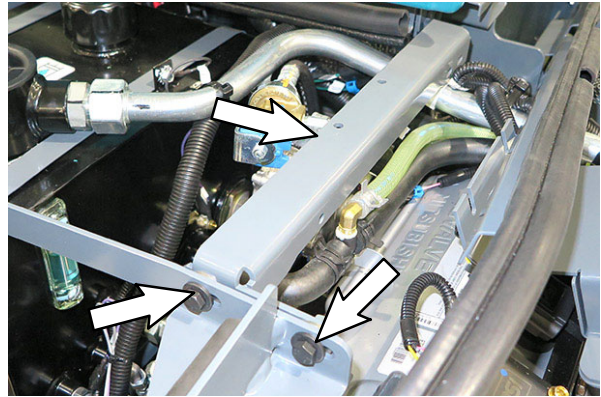

**FIG. 5**



**FIG. 6**

4. Remove the hinge support angle from the machine. Set the hardware aside. Discard the hinge support angle. (Fig. 7/Fig. 8)



**FIG. 7**

5. Use removed hardware to install the rear cover support bracket (10) onto the machine. (Fig. 7/Fig. 8)
6. Reinstall hardware removed to access the hex screw securing the hinge support bracket to the machine. (Fig. 3/Fig. 4/Fig. 5/Fig. 6)

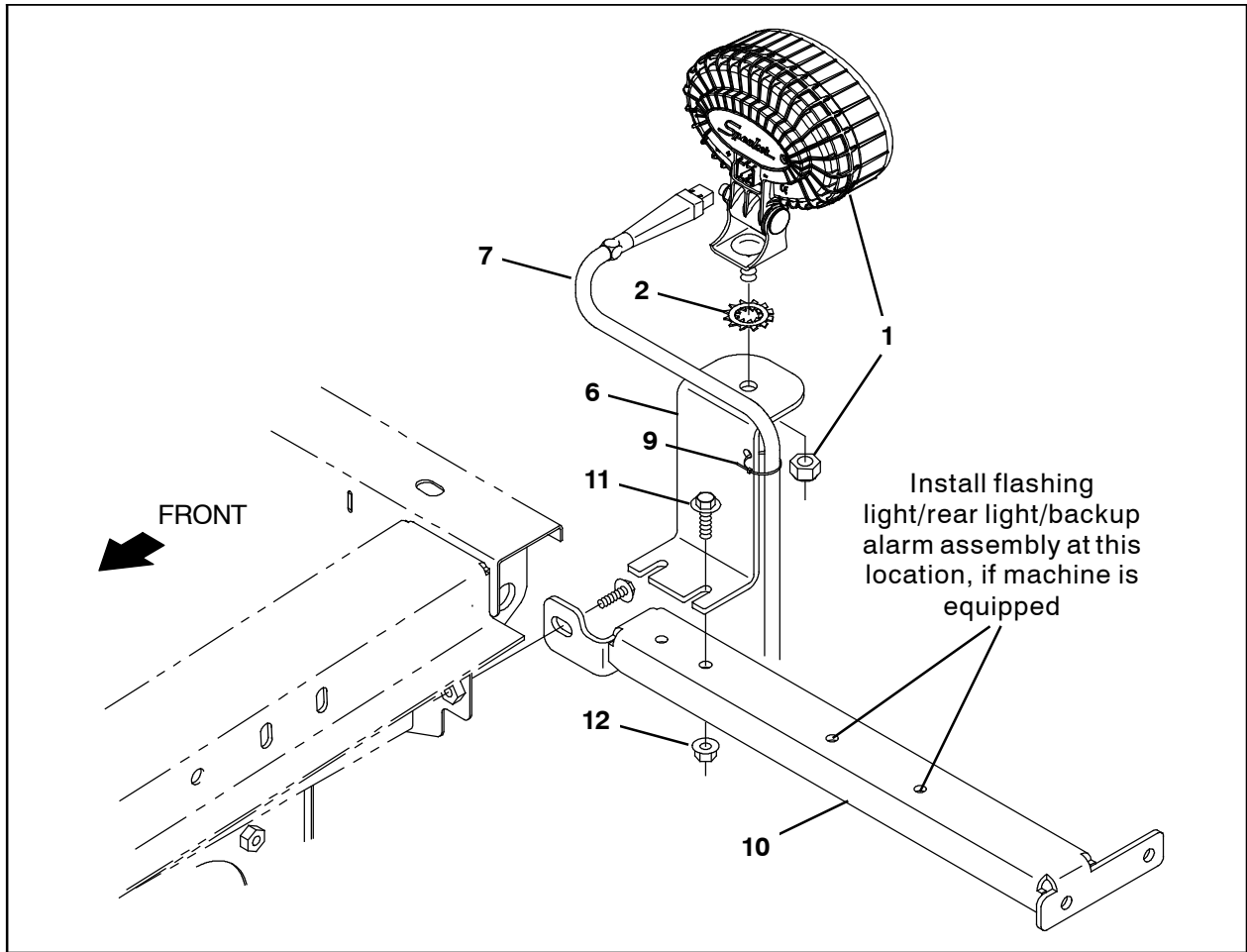

**FIG. 8**

7. **Machines equipped with flashing light/rear light/backup alarm assembly:** Install the flashing light assembly onto the rear cover support bracket (10). (Fig. 9)
8. Use two SEMS M6 hex screws (11) and two M6 hex nuts (12) to install the rear LED spotlight bracket (6) onto the rear cover support bracket (10). (Fig. 8/Fig. 9)

9. Remove the hex nut from the blue LED spotlight (1). (Fig. 9)
10. Use the hex nut removed from the blue LED spotlight (1) in the previous step and one lock washer (2) to install the blue LED spotlight onto the rear LED spotlight bracket (6). (Fig. 9/Fig. 10)

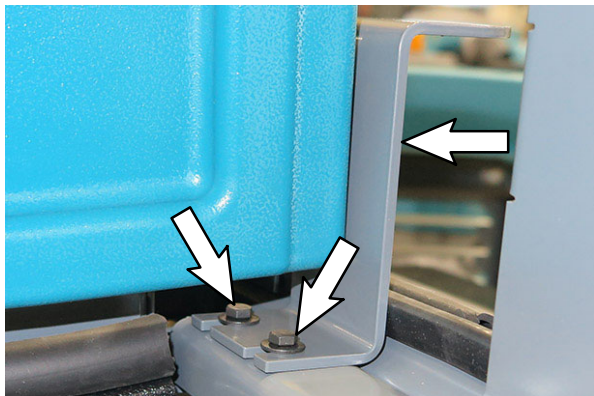

**FIG. 9**



**FIG. 10**

*NOTE: If machine has location for installing front spotlight mounting bracket onto the front lintel proceed to Step 15.*

**11. Machines without location for routing blue spotlight harness (13) through front lintel:** Measure and mark the location for the 1.375 in. (34.92 mm) hole to be drilled into the front lintel. (Fig. 11)

**12. Machines without location for mounting front spotlight mounting bracket (3) on front lintel:** Measure and mark the location for the 0.396 in. (10.20 mm) hole to be drilled into the front lintel. (Fig. 11)

**13. Machines without location for routing blue spotlight harness (13) through front lintel:** Drill a 1.375 in. (34.92 mm) hole into the front lintel. (Fig. 11)

**14. Machines without location for mounting front spotlight mounting bracket (3) to front lintel:** Drill a 0.396 in. (10.20 mm) hole into the front lintel. (Fig. 11)

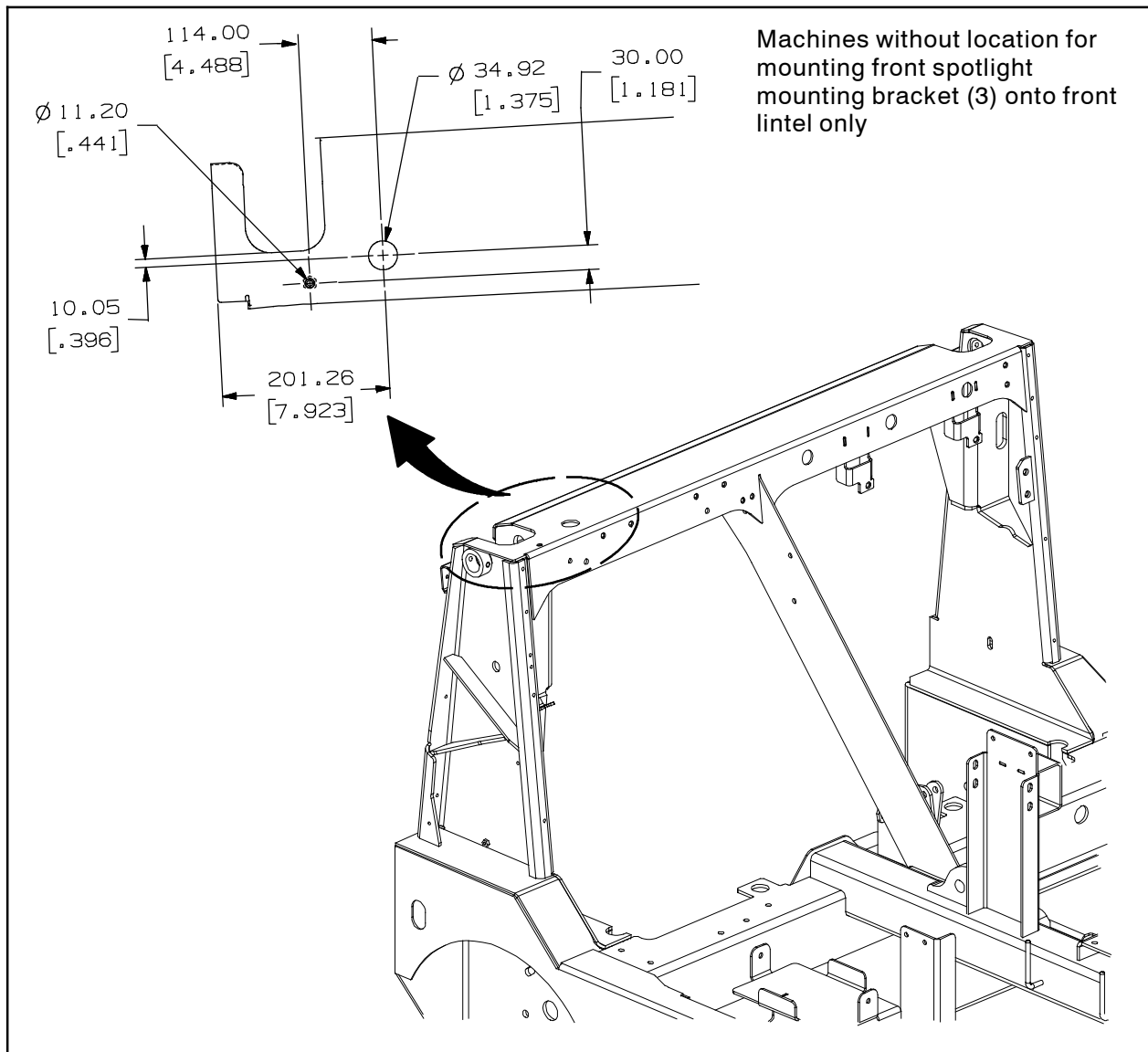

**FIG. 11**

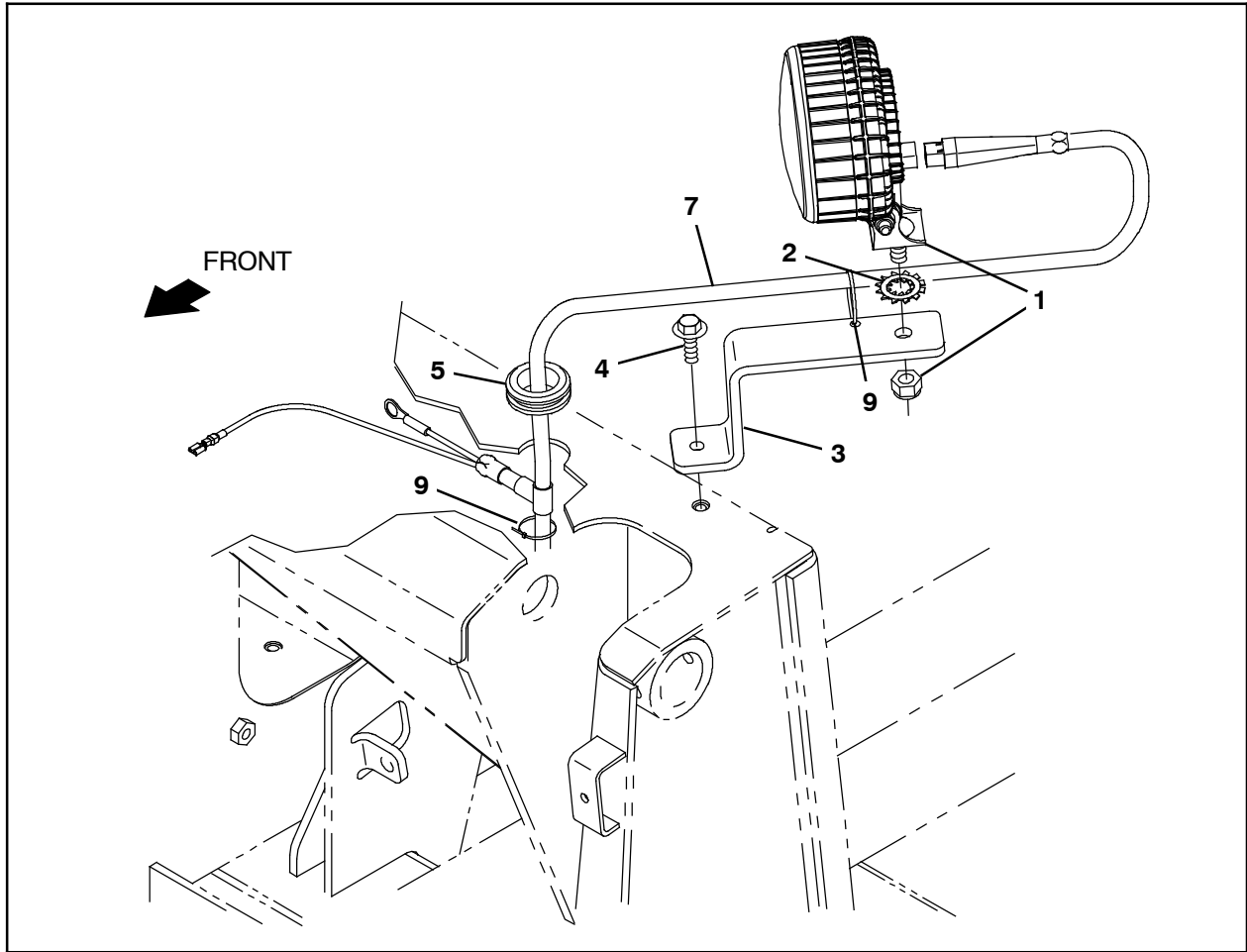
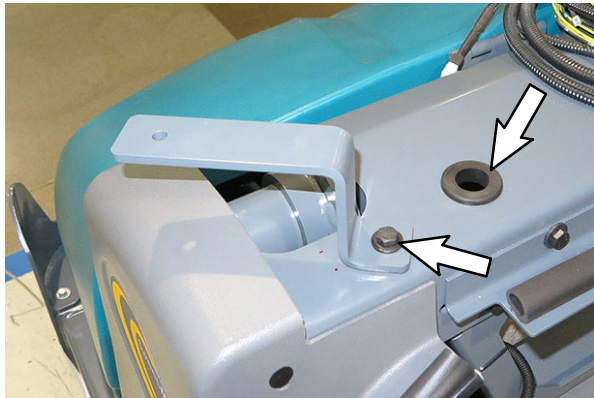

**FIG. 12**

15. Use one SEMS M8 hex screw (4) to loosely install the front spotlight mounting bracket (3) onto the front lintel. Do not completely tighten the SEMS M8 hex screw. (Fig. 12/Fig. 13)

17. Remove the hex nut from the blue LED spotlight (1). (Fig. 12)

18. Use the hex nut removed from the blue LED spotlight (1) and one lock washer (2) to install the blue LED spotlight onto the front spotlight mounting bracket (3). (Fig. 12/Fig. 14)



**FIG. 13**

16. Insert the grommet (5) into the hole in the front lintel. (Fig. 12/Fig. 13)

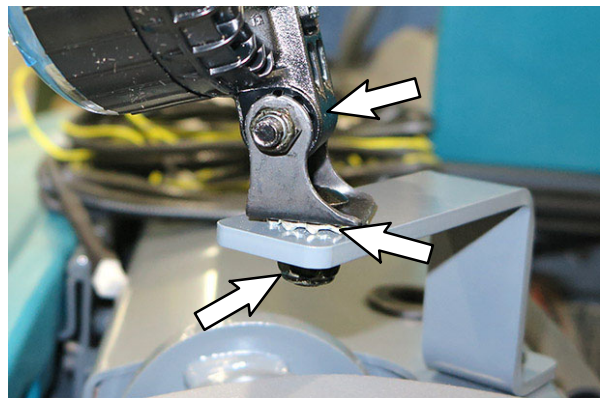

**FIG. 14**

19. Turn on the machine, completely raise the hopper, turn off the machine, and engage the hopper support bar.

20. Check the front blue LED light (1) positioning with the fully raised hopper. The raised hopper should not touch the front blue LED light. (Fig. 15)



**FIG. 15**

Adjust blue LED light bracket (3) as necessary and tighten the SEMS M8 hex screw (4) to fully secure the bracket to the front lintel. (Fig. 12/ Fig. 13)

21. Turn on the machine, lower the hopper until the hopper support is resting on the support bracket, and turn off the machine.

**FOR SAFETY: Before leaving or servicing machine, stop on level surface, turn off machine, and remove key.**



**WARNING: Lift arm pinch point. Stay clear of hopper lift arms.**



**WARNING: Raised hopper may fall. Engage hopper support bar.**

22. Disconnect the battery cables from the battery.



**WARNING: Always disconnect battery cables from machine before working on electrical components.**

23. Cut ties securing the rubber dust skirt to the front of the operator station/frame of the machine. (Fig. 16)



**FIG. 16**

24. Pull skirt back enough to allow access to the back of the relay/fuse panel, the main wire harness, and allow routing of the blue spotlight harness (7). (Fig. 16)

25. Position the blue spotlight harness (7) into the engine compartment so the rear blue light lead and the ground leads can each be routed to the respective locations. (Fig. 17)

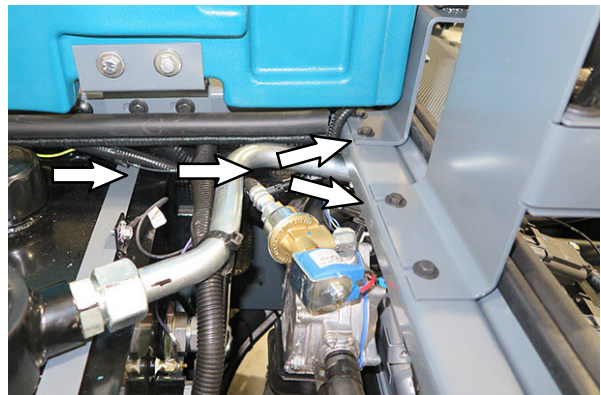

**FIG. 17**

26. Connect the blue spotlight harness (7) to the rear blue LED light (1). (Fig. 18/ Fig. 23)

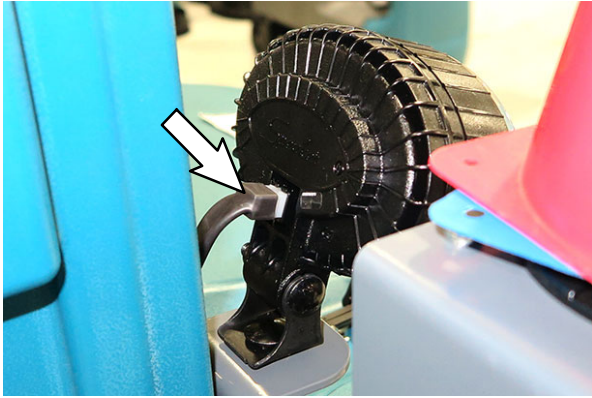

**FIG. 18**

27. Use a cable tie (9) to secure the blue spotlight harness (7) to the rear LED spot light bracket (6). (Fig. 19)

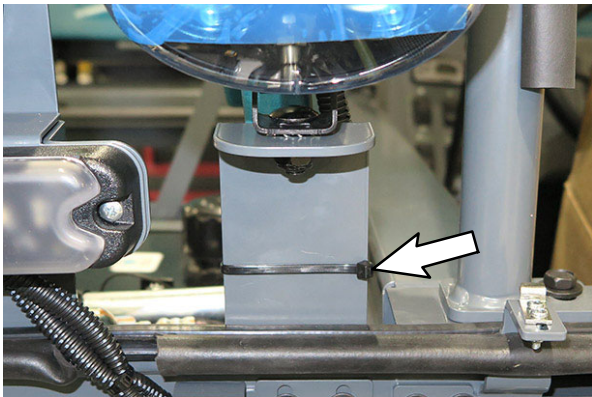

**FIG. 19**

28. Route the blue spotlight harness (7) ground lead under the hinge support angle (10), along the main wire harness, and to the engine main ground located behind the engine oil filter. (Fig. 20/ Fig. 23)

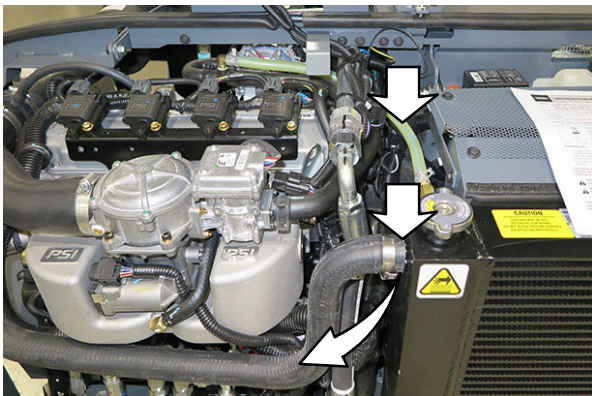

**FIG. 20**

29. Connect the blue spotlight harness (7) ground lead to the engine main ground. (Fig. 21/ Fig. 23)



**FIG. 21**

30. Use several cable ties (9) to secure the blue spotlight harness (7) ground lead to the main wire harness and away from moving parts or hot areas of the engine.

31. Route the blue spotlight harness (7) along the main wire harness and to the front of the machine. (Fig. 22/ Fig. 23)

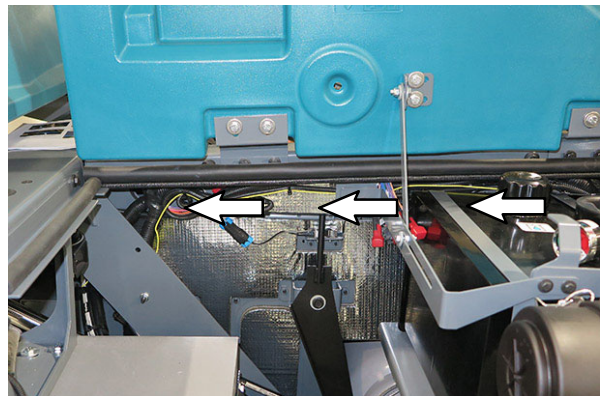

**FIG. 22**



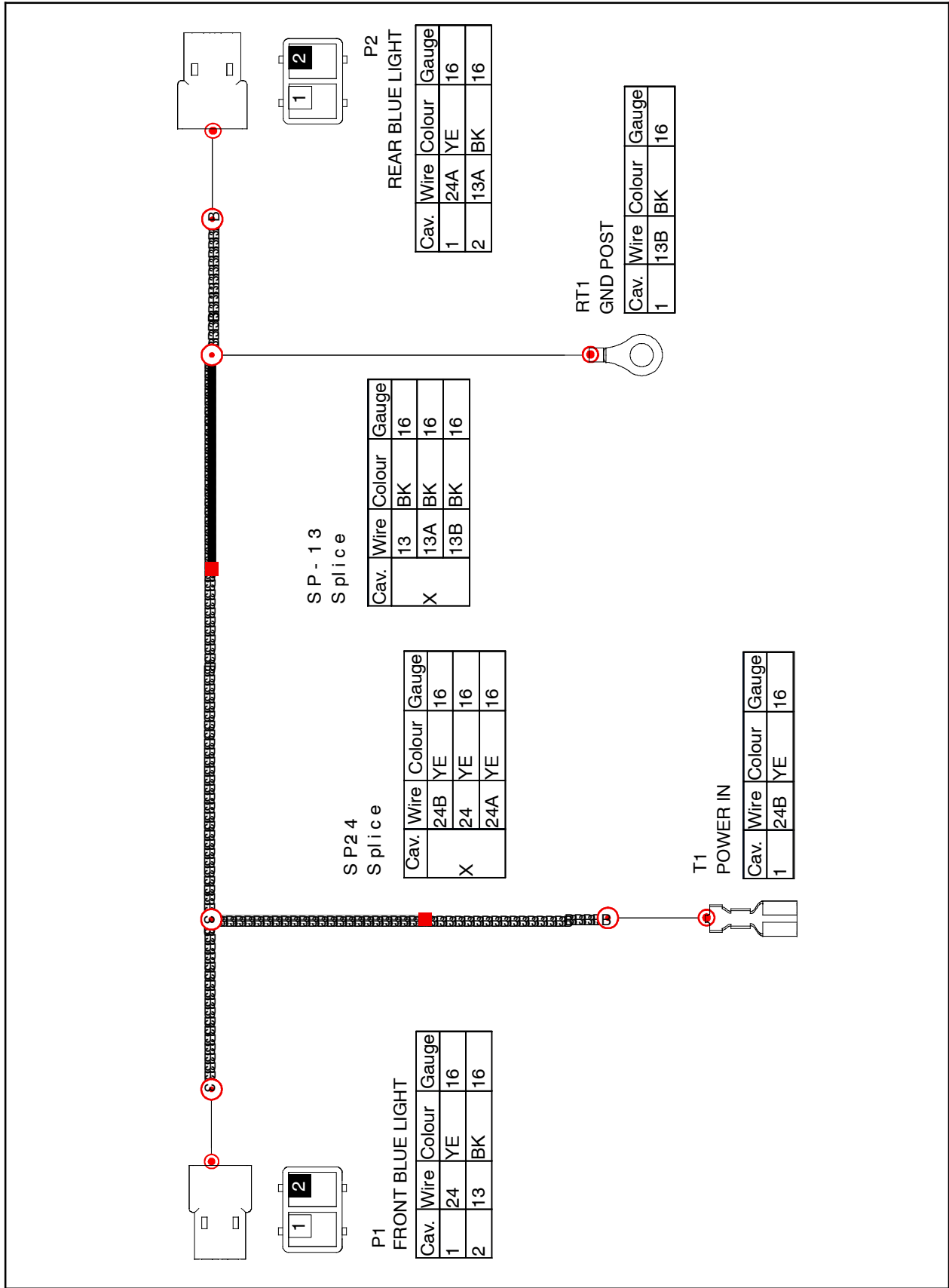
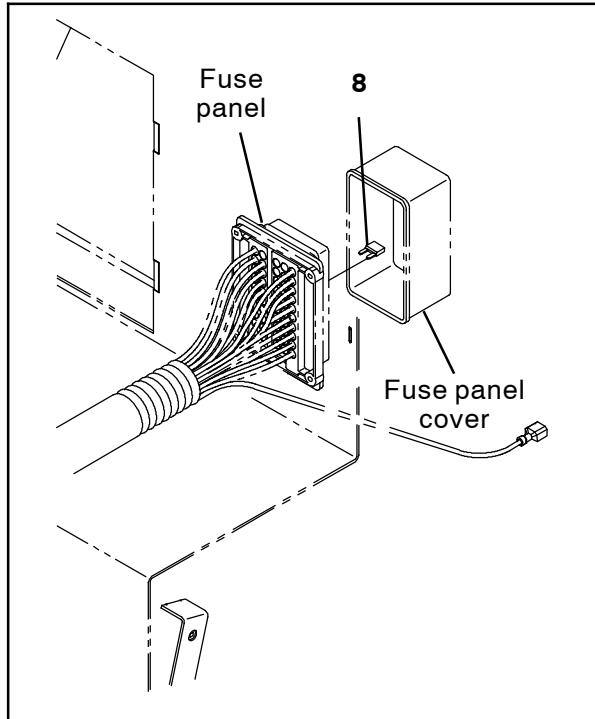

FIG. 23

32. Remove the fuse panel cover from the fuse panel. (Fig. 24)



**FIG. 24**

33. Insert the 5- Amp fuse (8) into the fuse panel. (Fig. 25/Fig. 24)

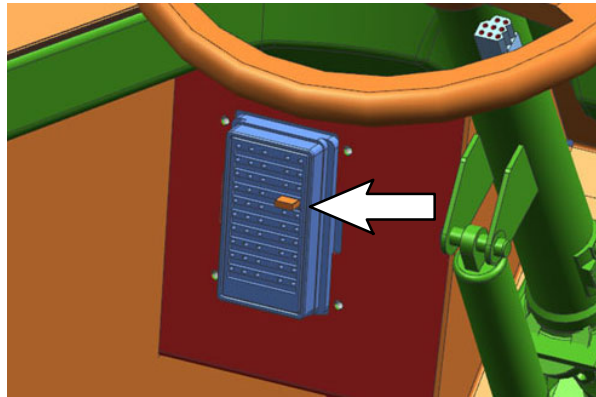

**FIG. 25**

34. Reinstall the fuse panel cover onto the fuse panel. (Fig. 24)

35. Connect the blue spotlight harness (7) T1 POWER IN yellow lead to the main wire harness CP16 OPTION tan wire. (Fig. 26/ Fig. 23)

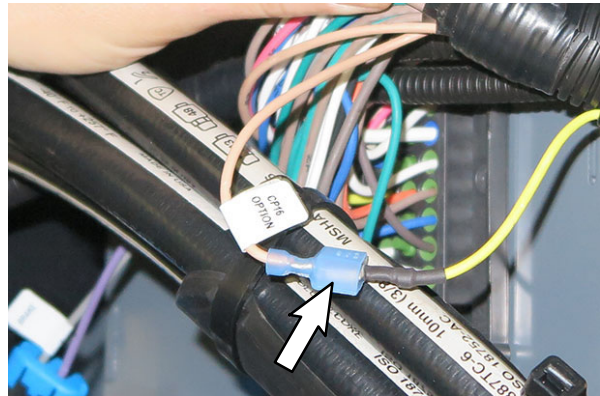

**FIG. 26**

36. Route the blue spotlight harness (7) along the front lintel and up through the grommet (5) in the front lintel. (Fig. 27)

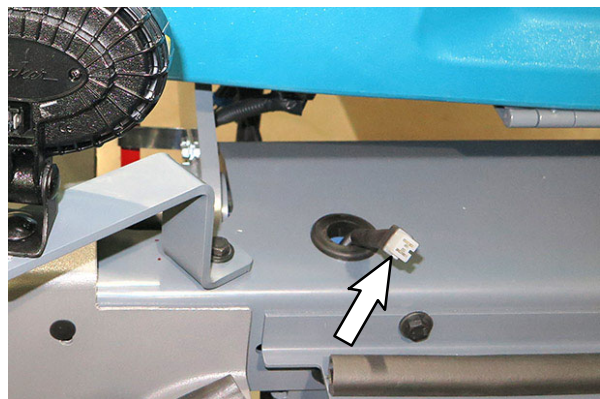

**FIG. 27**

37. Connect the blue spotlight harness (7) to the front blue LED spotlight (1). (Fig. 28/Fig. 23)

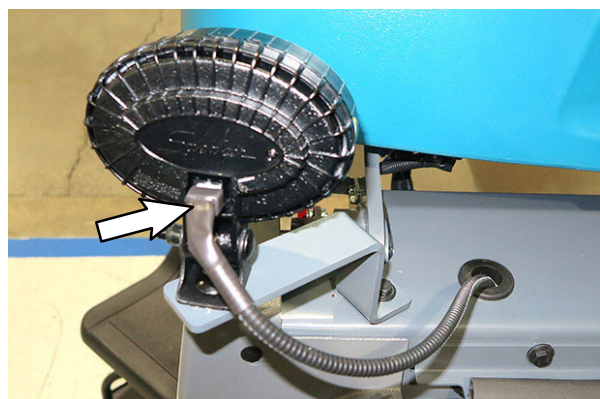

**FIG. 28**

38. Use cable ties (9) to secure the blue spotlight harness (7) to the front bracket. (Fig. 28)

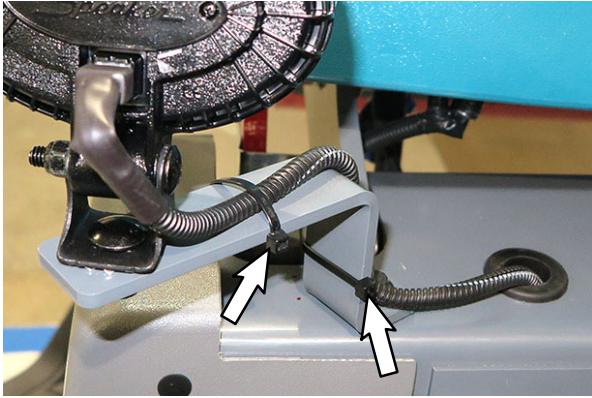

FIG. 29

39. Use cable ties (10) as necessary to secure the blue spotlight harness (7) to the alarm/strobe harness.

40. Reinstall the rubber dust skirt onto the front of the operator station/frame of the machine. Install cable ties to secure the rubber dust skirt to the machine.

41. Reconnect the battery cables to the battery.

42. Reinstall/close shroud and covers.

43. Start and test the machine. Both blue lights should immediately illuminate when the machine is started.

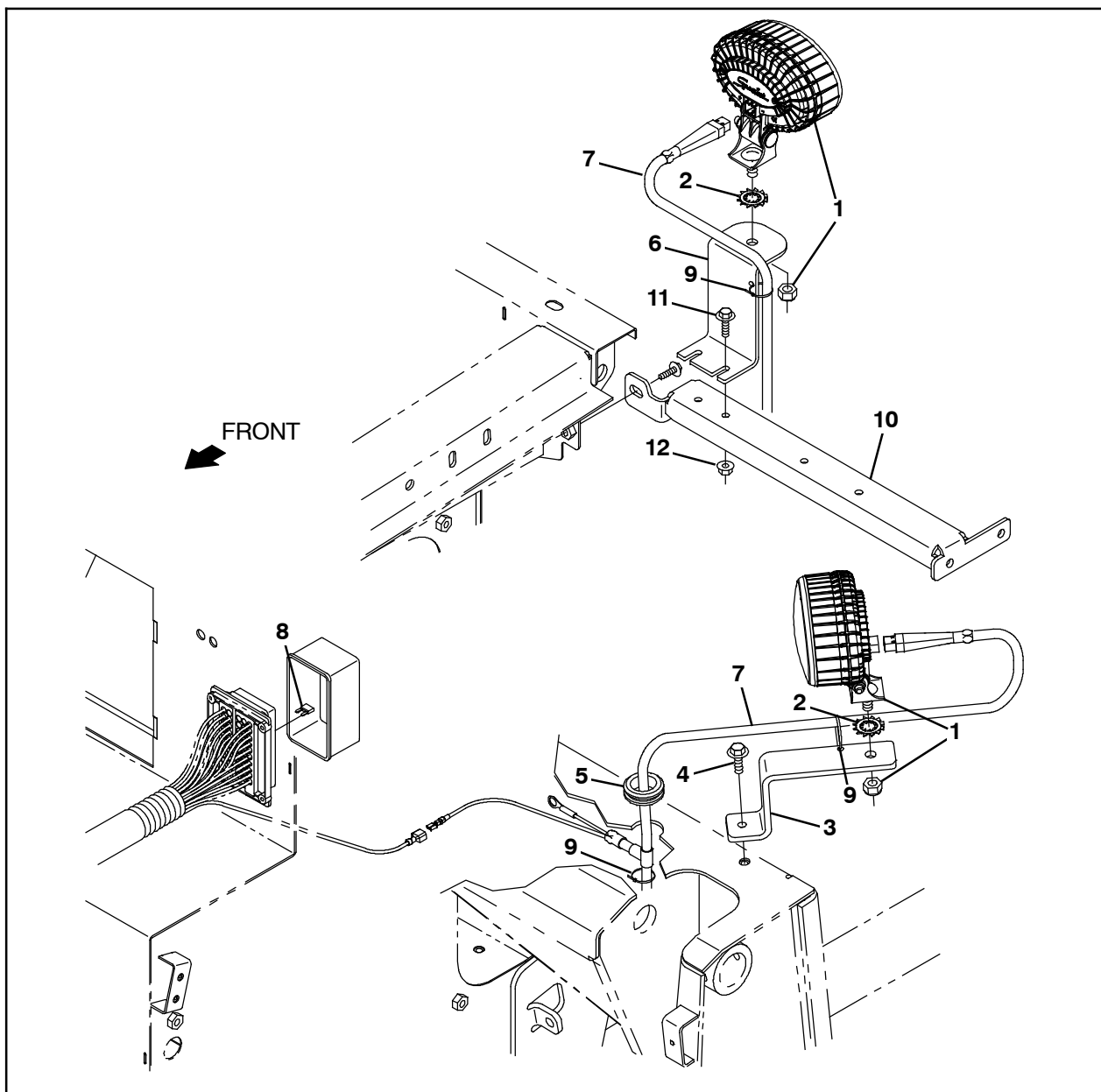

FIG. 30

---

**Bill Of Materials For Kit, Spotlight, Blue, CI [S30] - 9020927**

<b>Ref.</b>	<b>Tennant Part No.</b>	<b>Description</b>	<b>Qty.</b>
1	1240687	Light, Spot, Blue, LED	2
2	41143	Washer, Lock, Int- Ext, 0.50	2
3	1262944	Brkt, Blue Spotlight, Front [S30]	1
4	1037354	Screw, Hex, M8 X 1.25 X 30, 9.8, SEMS	1
5	10632- 1	Grommet, Rbr, 1.06id, F/1.4h, .19 Matl	1
6	1263707	Bracket, Blue Spotlight, Rear [S30]	1
7	1076776	Harness, Blu Spotlight [S30]	1
8	1049734	Fuse, Blade, 005a, 32vdc [Mini]	1
9	763114	Tie, Cable, 11.3l, 2.75d Max	10
10	1264246	Bracket, Sppt, Cover, Rear, LH	1
11	1036892	Screw, Hex, M6 X 1.00 X 25, 9.8, SEMS	2
12	07790	Nut, Hex, Flng, M6 X 1.00	2

TENNANT COMPANY  
10400 Clean Street  
Eden Prairie, MN 55344- 2650